

WYRESTORM EXPRESS DOLBY DIGITAL TO ANALOGUE AUDIO CONVERTER

EXP-CON-DAC-D



The WyreStorm Audio DAC-D allows any Dolby Digital audio signal to be converted to a stereo analogue signal for connection to AVR, Hi-fi or other audio devices, with switchable input select and LED power indication.

KEY FEATURES

- Compact design
- Optical & Digital Coaxial inputs
- Convert PCM digital audio from a compatible device to analogue stereo audio
- Input Select switch
- LED Power indication
- Supports audio signals up to 24-bit with sampling rates up to 192 kHz
- Low-latency Digital Filtering
- Dynamic Range: 106 dB A-wt
- THD+N (Total harmonic distortion plus noise) rating: -93dB

IN THE BOX

- 1 x WyreStorm EXP-CON-DAC-D Analogue audio converter
- 1 x Universal 5V DC/1A power supply



WIRING DIAGRAM

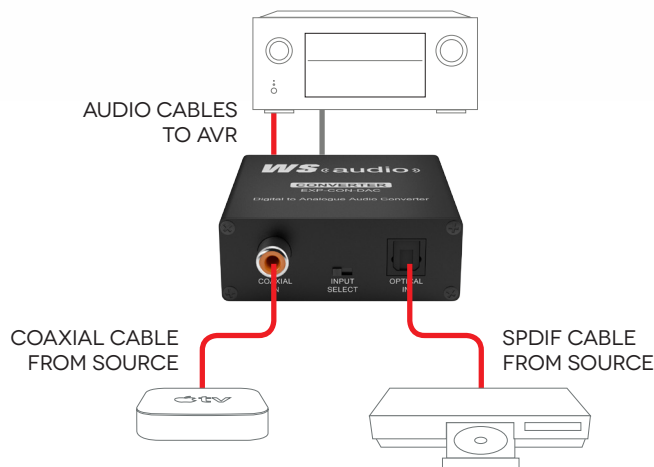

SPECIFICATIONS

Dimensions (WxHxD):	64mm x 24mm x 63mm / 2.5" x 0.9 x 2.4"
Weight (Kg):	86g / 3.03oz
Operating Temperature Range:	0 to +35°C (32 to +95°F)
Operating Humidity Range:	5 to 90 % RH (no condensation)
Audio Format Supported:	44.1KHz Stereo PCM, Dolby Digital 5.1
Power Supply:	5VDC - from mains, Max Power: 1.0w

WyreStorm Express products include a twelve month manufacturer warranty.



US OFFICE:
TEL: +1 901 384 3575
FAX: +1 901 384 3574

EMEA OFFICE:
TEL: + 44 (0) 1793 230 343
FAX: + 44 (0) 1793 230 583